

Daily use

How to lookup an SDS by scanning Barcode (EAN-/UPC-code)

To find a Safety Data Sheet for a product, you first scan the QR code to access your SDS library.



Next, you click the barcode icon in the search bar (1), scan the barcode (2), and click the search icon (3) after the barcode has been detected.

Daily use

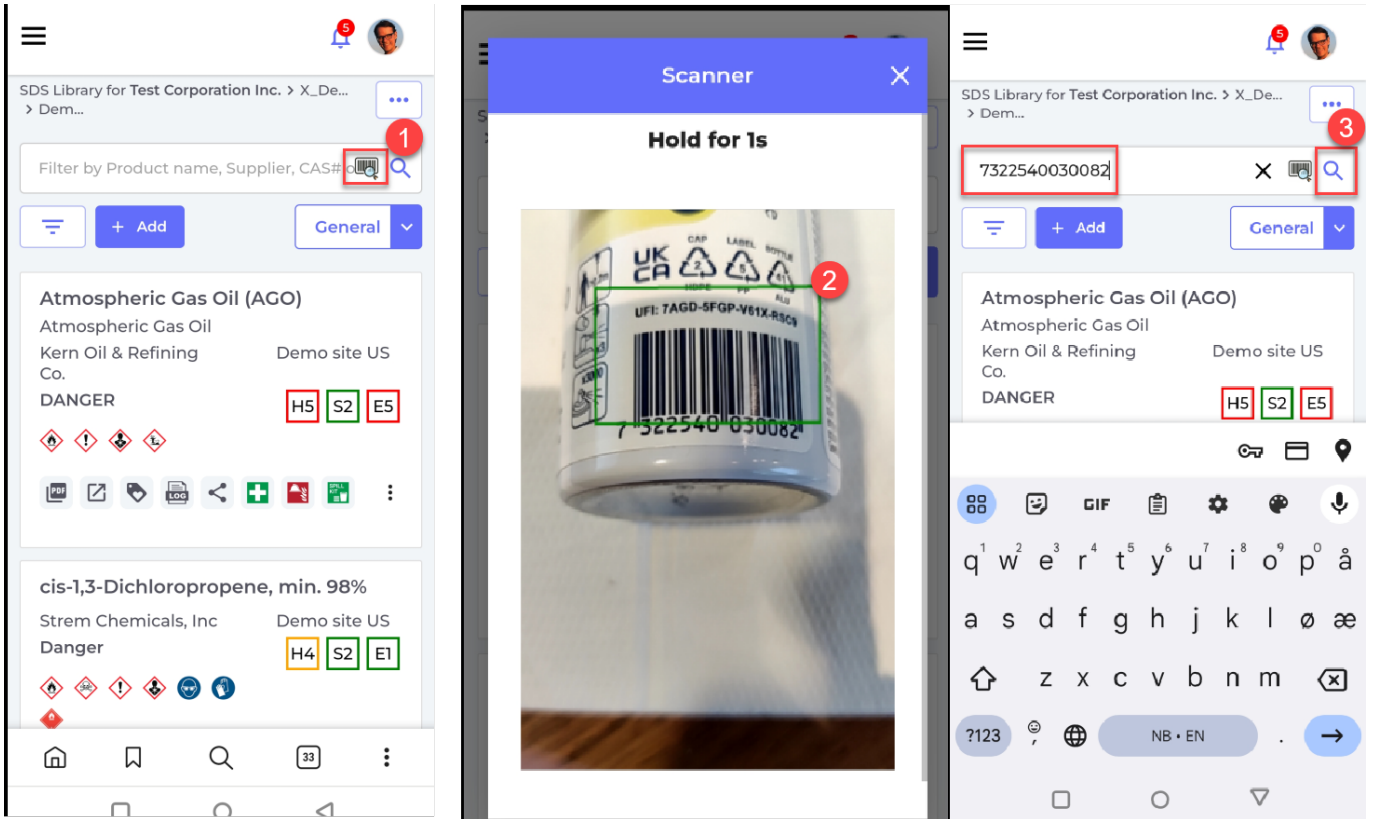

Very few Safety Data Sheets have EAN/UPC codes, so to be able to let your employees find SDS by scanning barcodes, you must first add the barcodes for your products.

Admin access is needed to add EAN/UPC codes. you can add multiple codes to same SDS

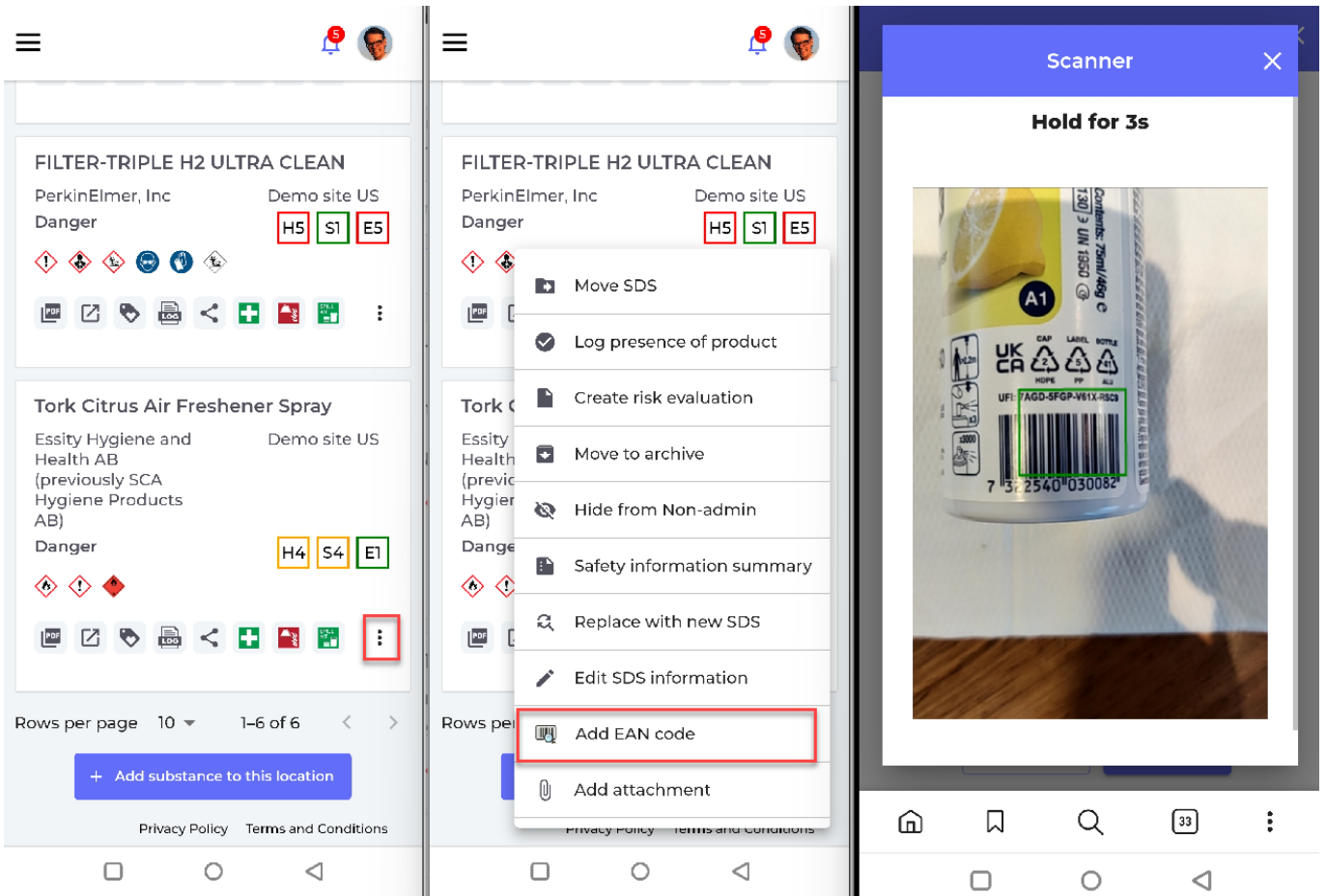

Daily use

On [Manage SDS library](#) (require login), you can use the filter to find SDS that is missing EAN/UPC code.

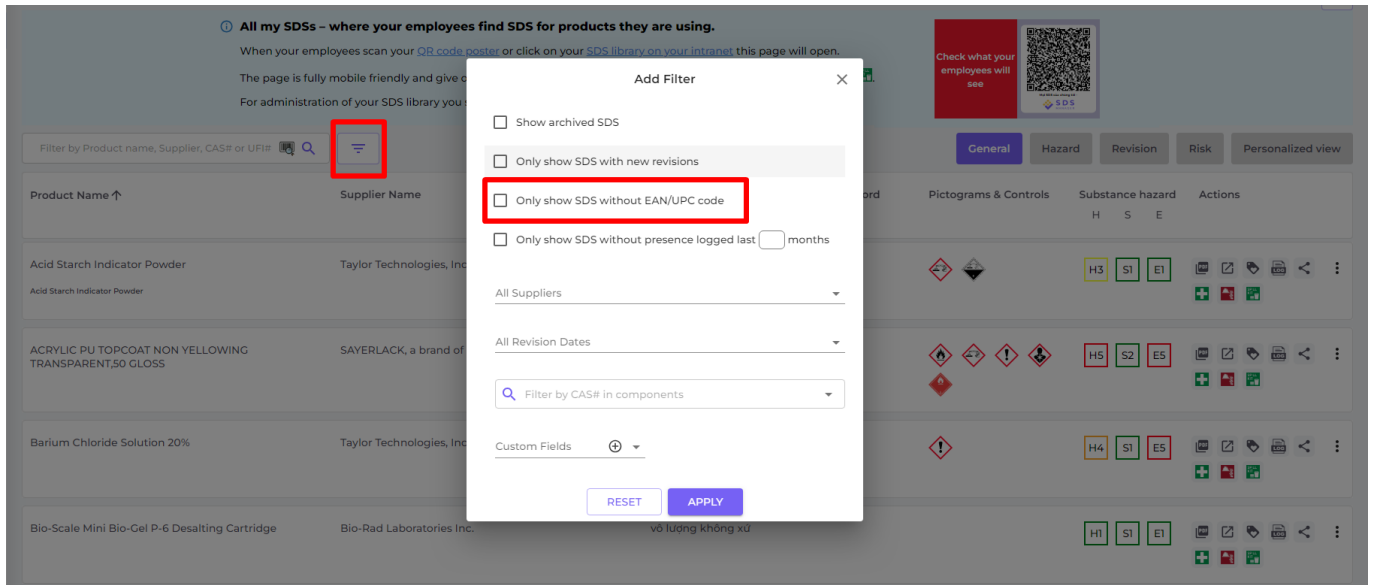

Unique solution ID: #1141

Author: n/a

Last update: 2024-11-20 11:23